

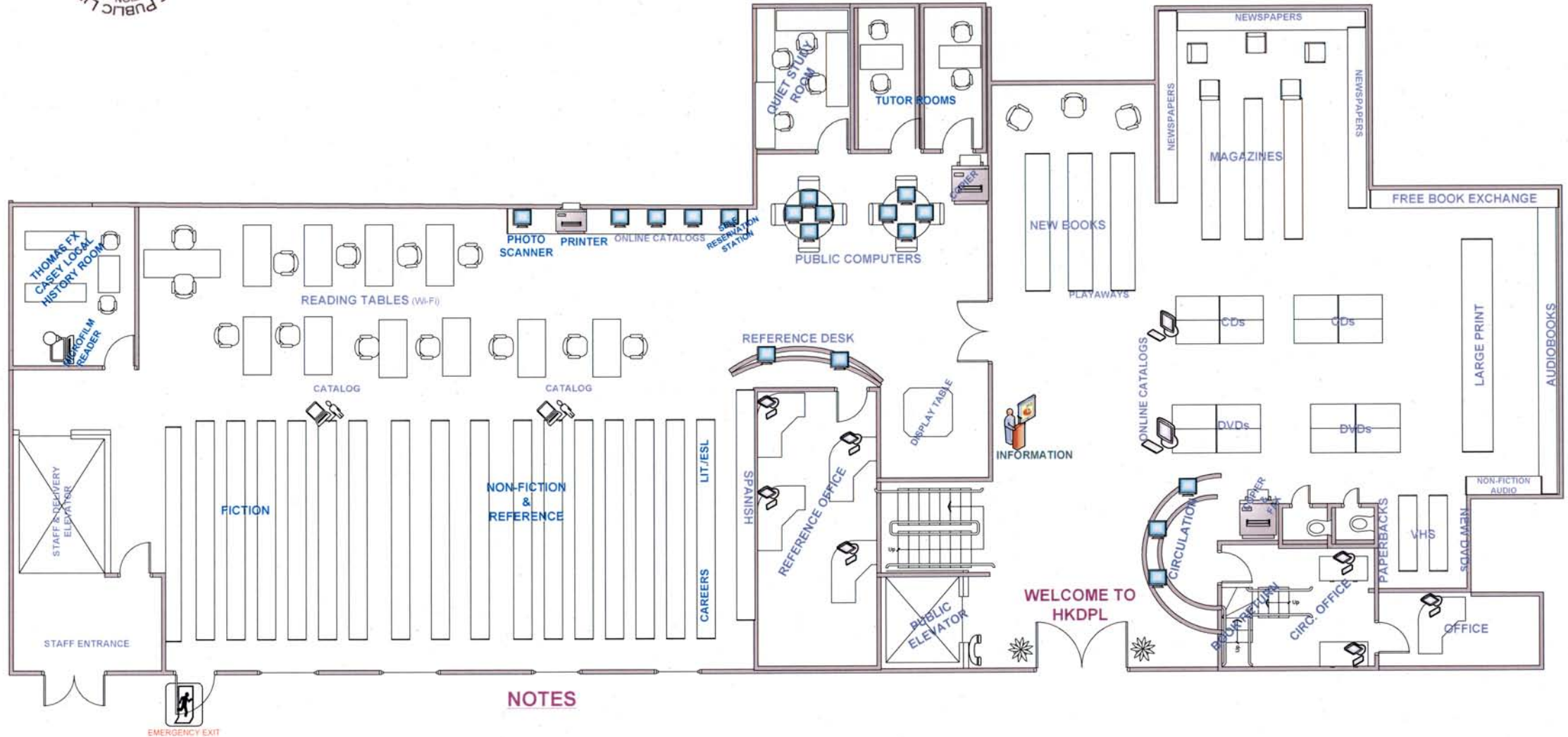

**ENTRY LEVEL:
[ADULT SERVICES, CIRCULATION, AUDIO VISUAL
& PERIODICALS]**



NOTES

- **NON-FICTION & REFERENCE INCLUDES BIOGRAPHIES (SHELVES 1-10)**
- **FICTIONS INCLUDES PULL-OUT COLLECTIONS OF AFRICAN AMERICAN FICTION & SCI-FI (SHELVES 11-17) [MYSTERIES ARE DOWNSTAIRS ON MID-LEVEL, NEXT TO COMPUTER AREA.]**
- **LITERACY, ESL, PHONE BOOKS & CAREERS ARE OPPOSITE SPANISH COLLECTION**

**MID-LEVEL
[YOUTH SERVICES, TEEN ROOM
& COMPUTER CENTER]**

